

WS8000**5KW AIR COOLED DIESEL GENERATOR**

Features and benefits

■ BASIC INFORMATION

5KW silent diesel generator,
50HZ ,220/380V, three phases

■ LONG TIME TESTING

For model testing: More than 800 hours running test;
Engine test: At least 50 minutes

5KW

AIR COOLED DIESEL POWER

Generator test: At least 60 minutes

■ GOOD PERFORMANCE

With brushless alternator (KETE brand, Linz brand is optional)
GEC7010C auto start control panel

Key spare parts import,

| Key Parts Items | Brand |
|-------------------------|--------------------------------|
| Injector | BOSCH |
| Stop oil solenoid valve | BOSCH |
| Bearing | NSK |
| Standard parts | 10.9 G |
| Screw-thread glue | LOCTITE |
| Flywheel | Split type (Increase air flow) |
| Packing | PLYWOOD |

Optional 25L big fuel tank

■ CERTIFICATIONS

CE / ISO

■ WARRANTY

1 years /1000 hours limited warranty

■ PACKING

Makes for an easy and reliable transportation and installation

GENERATOR SPECIFICATIONS

| | |
|----------------------|---------------------------------------|
| Rated Power | 5.2KW |
| Max Power | 5.5KW |
| Rated Voltage (V) | 220/380 3P |
| Generator type | Brush, exciting-self voltage with AVR |
| Rated Frequency (Hz) | 50 |
| Rated Speed (rpm) | 3000 |
| Phase | Three |
| Power Factor | 0.8 |

ENGINE SPECIFICATIONS

| | |
|-----------------------------|--|
| Manufacturer/Model | WS188 |
| Engine Type | Single, air cooled, 4-stroke, direct injection |
| Displacement | 456 |
| Bore | 88 mm |
| Stroke | 75 mm |
| Compression Ratio | 20:1 |
| Starter motor rated voltage | DC 12V/0.8KW Electrical start |
| Danamo capacity | DC 12V/8.3A |
| Engine oil capacity | 1.65 liters |
| Fuel tank capacity | 15 liters |
| Continuous running time | 6.3 H |

SOUND EMISSIONS

| | |
|--------------------------------|----|
| Sound output in dB(A) at (7 m) | 72 |
|--------------------------------|----|

ENGINE COOLING SYSTEM

| | |
|----------------|-------------------------|
| Cooling system | Air cooled |
| Radiator Fan | Engine with its own fan |

UNIT DIMENSIONS AND WEIGHTS

| | |
|-------------------|--------------|
| Unit Weight (kg) | 185 |
| Gross Weight (kg) | 200 |
| Unit Size (in) | 1030*640*800 |
| Packing size (in) | 984*604*744 |
| Packing | Woodpack |
| 20ft Loading | 63 |

CONTROLLER FEATURES

- GEC7010C
- Automatic Star Module. It controls generator to start/stop by remote start signal
- GEC7010C/7020C with RS485 interface
- Low oil pressure
- Over load protection

GEC7010C panel indicators

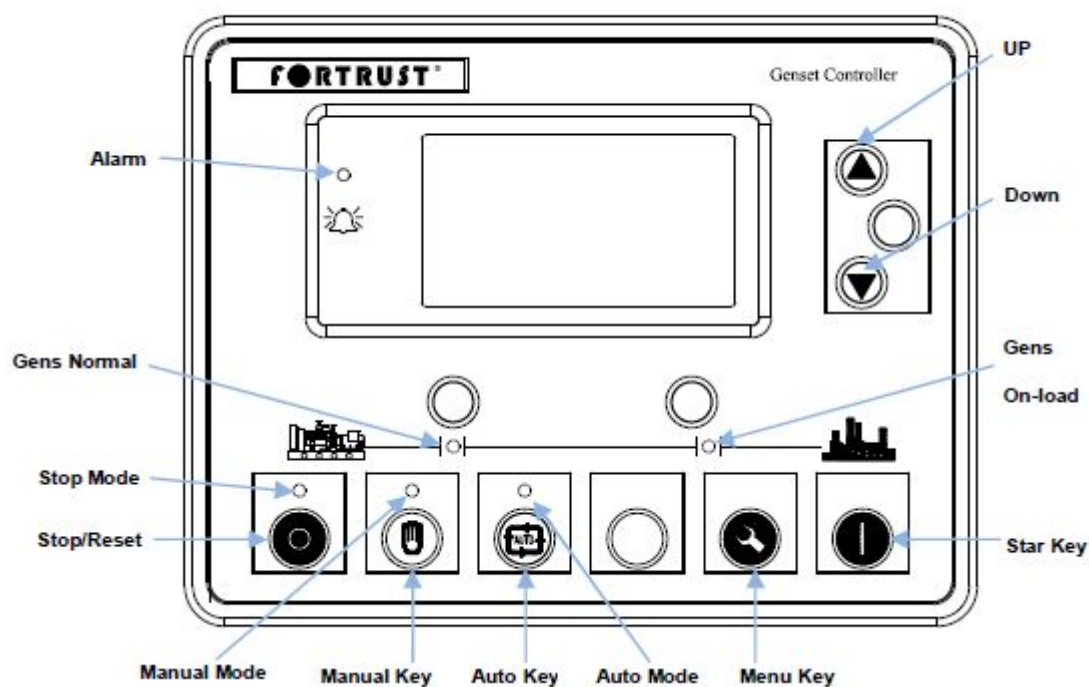

AVAILABLE ACCESSORIES

- | |
|-------------------|
| ● Battery |
| ● Battery Charger |
| ● Spare parts |